

CRANKCASE EXHAUSTER

DESCRIPTION

The crankcase exhauster, driven by an electric motor, is a centrifugal blower which exhausts crankcase vapors to the atmosphere. The entire assembly is mounted on top of the cylinder block at the power take-off end of the engine.

REMOVAL

1. Disconnect electrical connections to blower motor (conduit).
2. Remove lubricating oil drain pipe (13).
3. Remove mounting hardware and exhaust pipe from discharge side of blower.
4. Remove capscrews (9), washers (10), and lockwashers (11) connecting exhauster suction elbow to cylinder block.
5. Remove capscrews (17), washers (18), and lockwashers (19) holding blower motor to bracket.
6. Lift entire assembly off cylinder block.
7. Remove gasket (12).
8. Remove capscrews (2) and (5), washers (3) and (6), and lockwashers (4) and (7). Separate motor blower from suction elbow.
9. Remove gasket (1).

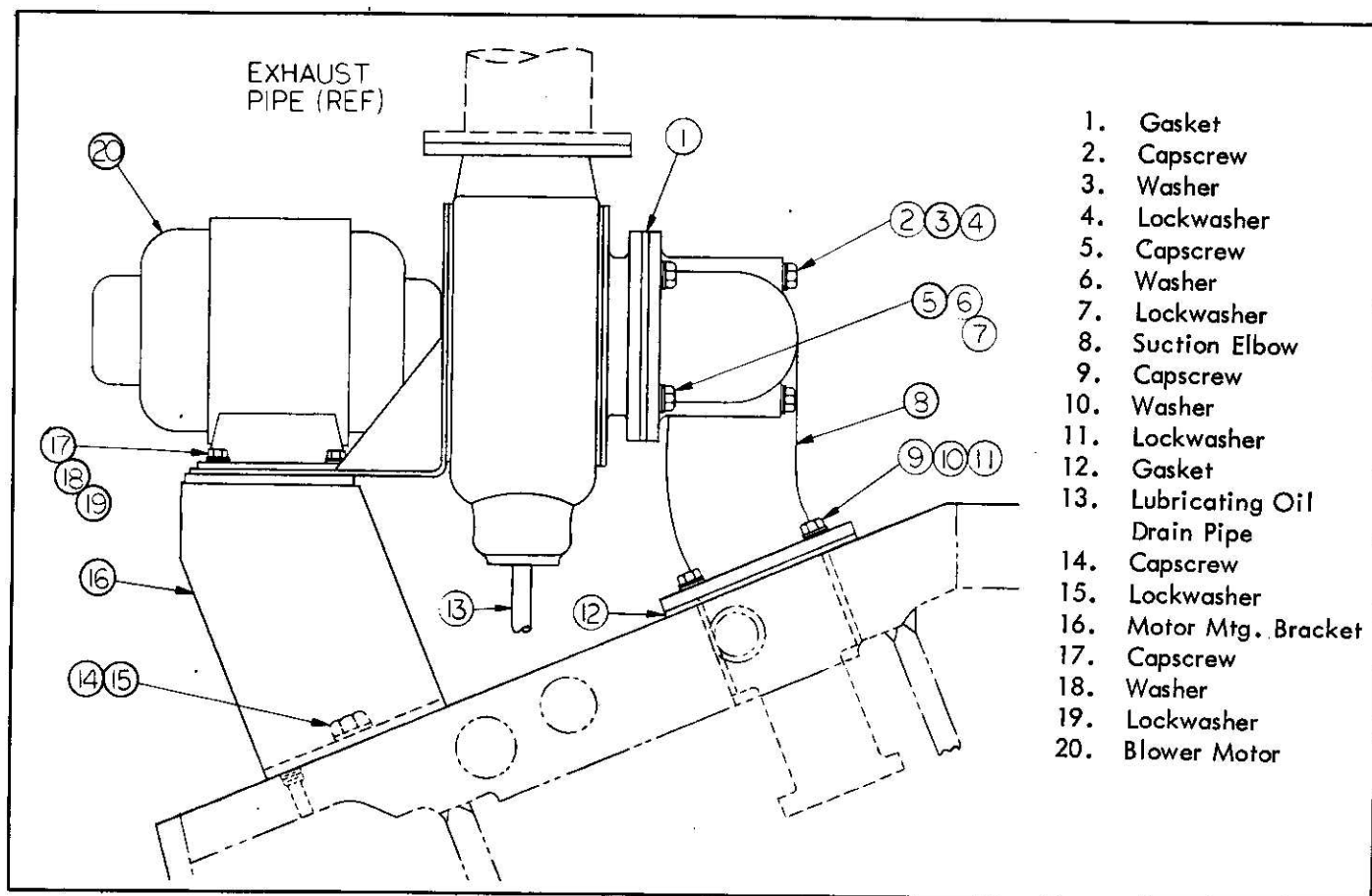

*FIG. 1. CRANKCASE EXHAUSTER

INSPECTION AND MAINTENANCE

1. Clean blower impeller, housing, and fan blades.
2. Clean exhaust and drain piping.
3. Check clearance between impeller and casing.
4. Check for impeller tightness on shaft.
5. Replace gaskets.

INSTALLATION

1. Install new gasket (1) between suction elbow and blower motor and reapply lock-

washers (4) and (7), washers (3) and (6), and capscrews (2) and (5).

2. Install new gasket (12).
3. Place assembly on cylinder head and apply lockwashers (11), washers (10), and capscrews (9) to exhaust suction elbow.
4. Apply lockwashers (19), washers (18), and capscrews (17) to blower motor.
5. Install lubricating oil drain.
6. Install exhaust pipe to discharge side of blower.
7. Apply electrical connections to blower motor.